

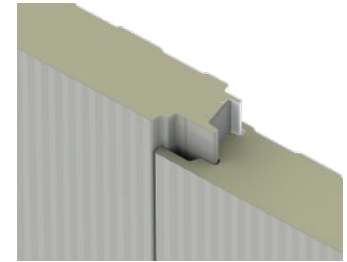

FALK HFW-40

HIDDEN FIXED WALL PANEL

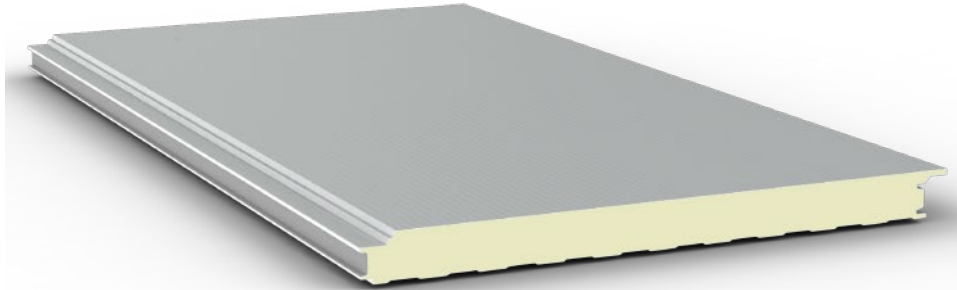

Core Thickness [in]	U-factor (IP) [BTU/h·ft ² ·°F]	R-value** [h·ft ² ·°F/BTU]	U-value (SI) W/(m ² ·K)
63.5 mm / 2.5 in	0.0557	17.95	0.316
76.2 mm / 3 in	0.0464	21.54	0.264
101.6 mm / 4 in	0.0348	28.72	0.198
127 mm / 5 in	0.0279	35.90	0.158
152.4 mm / 6 in	0.0232	43.08	0.132

* Tested at 4°C / 40°F Mean Temperature

** Catalog ratings are based on European test standards. Test results will be published on our website as soon as they become available.

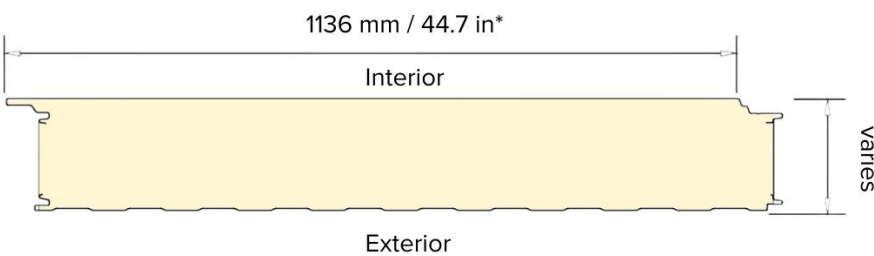

- Max. length up to 24994 mm / 82' ft
- Macro Rib, Micro Rib, Box Profile
- Colorcoat HPS200 Ultra®, Sherwin-Williams Fluropon® 70% PVDF, or Sherwin-Williams® SMP for exterior faces
- Designed for vertical and horizontal installation
- Hidden fastener
- Non-embossed available

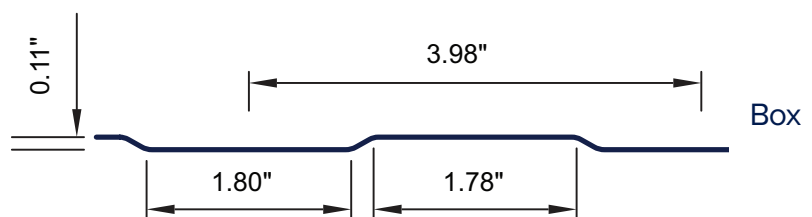
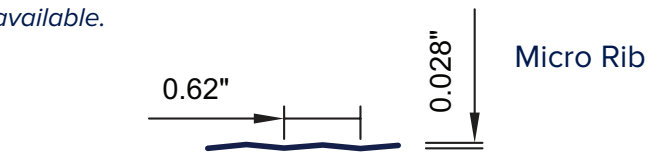

*Requires special transportation arrangements